

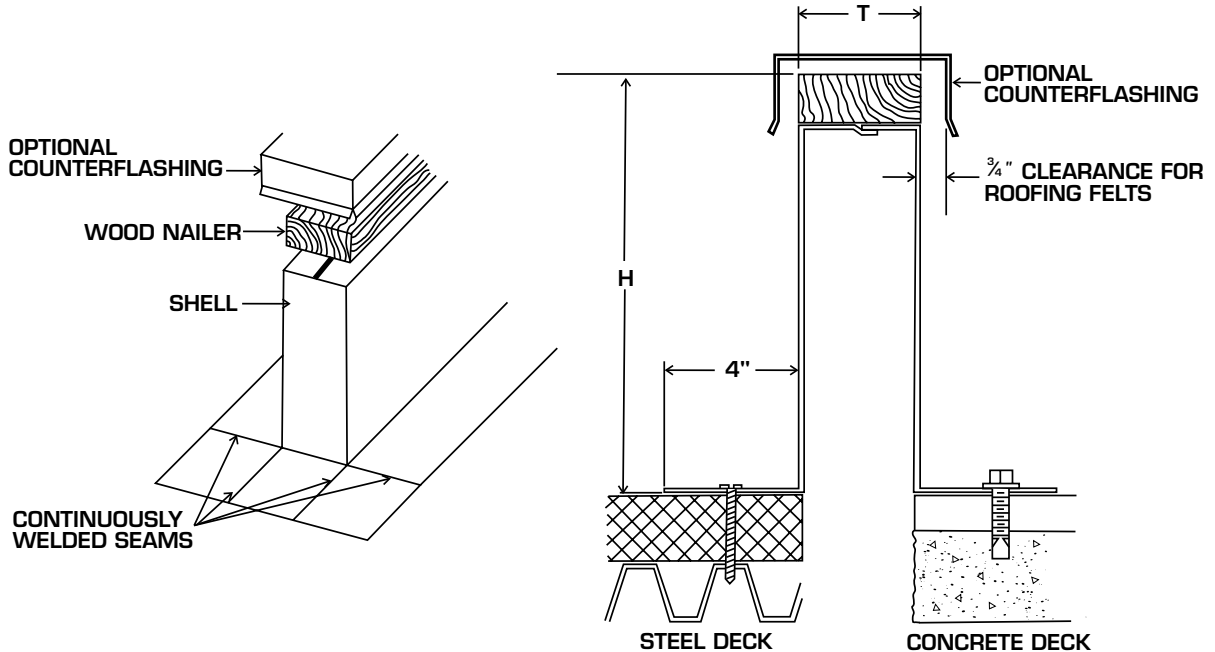

**CERTIFICATION & SUBMITTAL
 MODEL 8230 - EQUIPMENT SUPPORTS
 SELF FLASHING STYLE**



STANDARD SPECIFICATIONS

- **PLATE SHELL & BASE:** 18 ga. galvanized press formed steel. Continuous welds on shell seams. Internal reinforcing supports welded as required.
- **WOOD NAILER:** Fir, factory installed.
- **AVAILABLE "T" DIMENSIONS:**
 MODEL 8231: 1-1/2"
 MODEL 8233: 3-1/2" - standard
 MODEL 8235: 5-1/2"

OPTIONS

- 52 No nailer
- 53 Treated wood nailer
- 54 Oversized nailer
- 55 Neoprene gasket 1 1/2" or 2" x 1/4" (please specify)
- 65 One way pitch
- 67 Flashing cap
- 81 16 gauge construction
- 82 14 gauge. construction
- 86 Aluminum construction

NOTES

1. MINIMUM RECOMMENDED "H" = 8"
2. Large units, depending on freight requirements are shipped knocked down in multiple sections for field assembly.

